

ROWAN COUNTY  
Planning and Development  
Road Naming Petition



Return this completed petition form to:  
Rowan County Planning and Development  
Pamela Ealey, Planning Technician  
402 N Main Street  
Salisbury, NC 28144  
Phone: 704 216-8603 Fax: 704 216-7986  
Email: [pamela.ealey@rowancountync.gov](mailto:pamela.ealey@rowancountync.gov)

The General Statutes of the State of North Carolina, NCGS 153A-239.1, authorizes the Rowan County Board of Commissioners to name or rename any road within the County not lying within the corporate limits of a municipality. The address program administration (APA), which is comprised of staff from Rowan County's Information Technology Department's Geographic Information Systems (GIS) Division, Planning and Development Department and Emergency Services' Telecommunications Division, are assigned to administer this article.

This petition must be completed for all requests. If you are naming a private road, **please enclose a sketch of the road with all homes and resident's names and current addresses along the road.** It is very important to depict all homes on the diagram. These names and structures will be referenced with county tax maps to help ensure an accurate property address. In addition, all rental housing along the road with names and addresses of the current tenants should be included on the diagram. FOLLOWING THE DIRECTIONS THROUGHOUT THIS PETITION IS NECESSARY FOR PROCESSING IN A TIMELY MANNER.

**NEW NAME PROPOSED FOR THE ROAD:**

Please choose three different names for the proposed road name. These choices should be listed in order of preference. The APA utilizes the National Emergency Number Association (NENA) United States Civic Location Data Exchange Format (CLDX) Standard as a guide for establishing or accepting road names. Based on NENA CLDX guidance and in its discretion as administrator of this ordinance, the APA may reject any proposed road name that:

- 1. Is duplicated elsewhere in the county (including a municipality) or sounds deceptively similar to an existing road name. This includes the use of homophones, e.g. bear and bare, pen and pin.
- 2. Is not easily enunciated or pronounced, especially in any emergency.
- 3. Intends to use specific names of individuals or property owners along the road.
- 4. Uses directional identifiers (N, S, E, W) and thoroughfare abbreviations (way, alley, etc.) in conjunction with an existing road name for consideration as a proposed road name.
- 5. Uses special characters, such as hyphens, apostrophes, periods or decimals in road name.

PLEASE CALL PLANNING OFFICE TO VERIFY YOUR ROAD NAME CHOICE

PRIOR TO RETURNING PETITION.

First Choice: Crappie Jig Lane - staff  
Second Choice: \_\_\_\_\_  
Third Choice: \_\_\_\_\_

*It is also important to remember that any or all addresses along the road may be changed during the naming process*



ROAD NAME PETITION

We the undersigned present this petition and request that a public hearing be set by the Rowan County Board of Commissioners to consider the following matter indicated by a check mark (✓) and described below:

- ☒ Assignment of a name to an unnamed road.
- ☐ Changing the name of road.

Describe the location of road in relation to a major highway or state road: drive off of Pops River Rd which connects to SR2140 St. Matthews Church Rd in the 2200 block. Current name of the road, if it has no name, write "no name" No name . At no cost to the petitioners, Rowan County will erect a street sign after the road name has been approved by the process outlined below. However, if the petition seeks to change the name of an existing road a street sign fee of \$150 is required prior to the petition being processed.

Petitioners:

Petitioners are property owners who own property along the road being named. Along with each signature include the mailing address, telephone number, tax map and parcel number. In order for the petition to be processed, a majority of the PROPERTY OWNERS along the road must be in favor of the petition. A majority consists of 50% + 1 of the property owners. Petitions having less than a majority may be returned to the petition leader for additional signatures or may be submitted for boardof commissioner approval through the special consideration procedure. **UNANIMOUS** and **MAJORITY** petitions may be approved by the board of commissioners following a public hearing. **SPECIAL CONSIDERATION** petitions will be processed as follows:

**Less than majority** – All property owners along the road to be named will be notified by the APA of the proposed road name choice and that no additional petitions will be accepted for consideration. Final action on the petition will be taken by the board of commissioners.

**Lack of submittal** – Failure to return a road naming petition within thirty (30) days to the APA shall indicate that property owners along the road are agreeing to use the name proposed by the APA. Final action will be taken by the board of commissioners.

**All property owners will receive notification from the APA of the new road name and potentially their new address number after the board of commissioners' decision.**

Petition leader:

One of the property owners must be the petition leader, they will be the person the APA will communicate with should there be any questions or clarifications needed, **the petition leader should be the first signature below.** The petition leader must own property along the proposed road. The petition leader should coordinate all of the property owner's signatures and submit the completed petition to the Rowan County Planning and Development office.

Signature	Printed Name	Mailing Address	Phone Number	Tax Map#-Parcel #
letter to petition sent 6/28/22				
no response	Edith Cowble	3345 Old Union Ch. Rd		502 037



# Campground Map Rowan County, NC

CAUBLE EDITH F LYERLY  
Campground

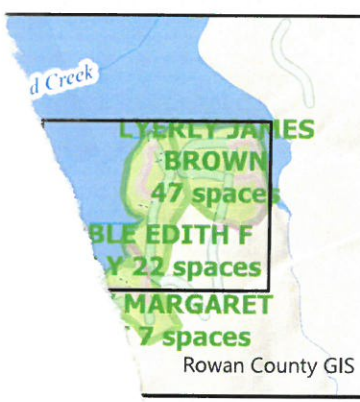

506  
0050000003

Crappie Lane  
Dig

TO BE NAMED

CAUBLE EDITH  
F LYERLY  
22 spaces

502 037

MILLER COVER COVER RD

Interlines

- UNNAMED DRIVE
- NEEDS TO BE NAMED
- NAMED DRIVEWAY



130  
Feet

2022

**ROWAN COUNTY**  
Geographic Information System  
Be an original.

Rowan County GIS  
ST MATTHEWS CHURCH RD  
509  
246

MARGARET H. TRUST  
53 spaces

1020 LOT 47



